

Technical Data Van Dorn EXTRA 90

Van Dorn Demag		Van Dorn EXTRA 90					
Model description		Van Dorn EXTRA 90-310			Van Dorn EXTRA 90-430		
International size description		800-310			800-430		
Clamping unit		90					
Clamping force	[US Tons] [kN]	[89.9] 800					
Locking force	[USTons] [kN]	[89.9] 800					
Max. mold opening stroke	[in] [mm]	[17.7] 450					
Min. mold height	[in] [mm]	[9.8/7.9/6.9] 250/200/175 ¹⁾					
Max. mold height	[in] [mm]	-					
Max. daylight	[in] [mm]	[27.6] 700					
Mould platen (h x v)	[in] [mm]	[21.3x21.3] 540 x 540					
Distance between tie bars (h x v)	[in] [mm]	[15.7x15.7] 400 x 400					
Ejection stroke	[in] [mm]	[5.9] 150					
Ejection force	[US Tons] [kN]	[4.6] 41					
Retraction force	[US Tons] [kN]	[1.7] 15					
Injection unit		310			430		
Screw diameter	[in] [mm]	[1.2] 30	[1.4] 35	[1.6] 40	[1.4] 35	[1.6] 40	[1.8] 45
L/D ratio		20	20	20	20	20	20
Injection pressure (up to 752°F)	[psi] [bar]	[189.9] 2755	[139.5] 2024	[106.8] 1550	[181.9] 2640	[139.6] 2025	[119.9] 1600
Cylinder head volume	[in ³] [cm ³]	[6.5] 106	[10.3] 168	[13.4] 220	[10.3] 168	[14.1] 231	[17.9] 293
Max. shot weight (PS, PE*)	[oz] [g]	[3.4] 95	[5.4] 152	[7.0] 198	[5.36] 152	[7.3] 208	[9.3] 263
Rate of injection							
> without accumulator	[in ³] [cm ³ /s]	[4.9] 80	[6.7] 110	[9.2] 150	[4.9] 80	[6.7] 110	[8.5] 140
> with accumulator	[in ³] [cm ³ /s]	-	-	-	-	-	-
Plasticizing rate (PS)							
> motor 1 (1740 psi)	[oz/s] [g/s]	[0.59] 16.6	[0.95] 26.9	[1.3] 37.1	[0.76] 21.5	[1.1] 29.8	[1.4] 39.9
> motor 2 (1740 psi)	[oz/s] [g/s]	[0.47] 13.3	[0.76] 21.5	[1.1] 29.8	[0.61] 17.2	[0.84] 23.7	[1.1] 31.8
Max. screw stroke	[in] [mm]	[5.9] 150	[6.9] 175	[6.9] 175	[6.9] 175	[7.2] 184	[7.2] 184
Max. distance of nozzle retraction	[in] [mm]		[9.8] 250			[11.8] 300	
Max. nozzle dipping depth (SVO)	[in] [mm]		[1.8] 45			[1.8] 45	
Nozzle sealing force	[US Tons] [kN]		[6.7] 60			[6.7] 60	
Number of heating zones		4	4	4	4	4	4
Hopper capacity	[gal] [L]		[9.2] 35			[9.2] 35	
General data		90-310			90-430		
Oil tank capacity	[gal] [L]	[47.5] 180			[47.5] 180		
Installed electrical rating							
> pump unit	[hp] [kW]	[20] 15.0			[20] 15.0		
> heating capacity of screw cylinder	[kw]	8.3	9.4	11.1	9.4	11.1	11.3
> total	[kw]	23.3	24.4	26.1	24.4	26.1	26.3
Dry cycles (EUROMAP 6)	[s-in] [s-mm]	2.78-285			2.78-285		
Net weight (without oil)	[lb] [kg]	[8333.3] 3750			[8444.4] 3800		
Machine dimensions (l x w x h)	[in] [m]	[159.1/50/71.3] 4.04x1.27x1.81			[162.6/50/71.3] 4.13x1.27x1.81		
Screw motor overhang (H) ²⁾	[in] [mm]	[0/0] 0/0	[0/1.0] 0/26	[0/5.9] 0/149	[0/0] 0/0	[0/4.3] 0/110	[0/10.5] 0/266

We reserve the right to make changes as a result of further technical advantages. Plasticizing rate depends on processing conditions and material employed.

- 1) max. opening stroke is constant for all mold heights
2) carriage forward/carriage back

Machine dimensions Van Dorn EXTRA 90

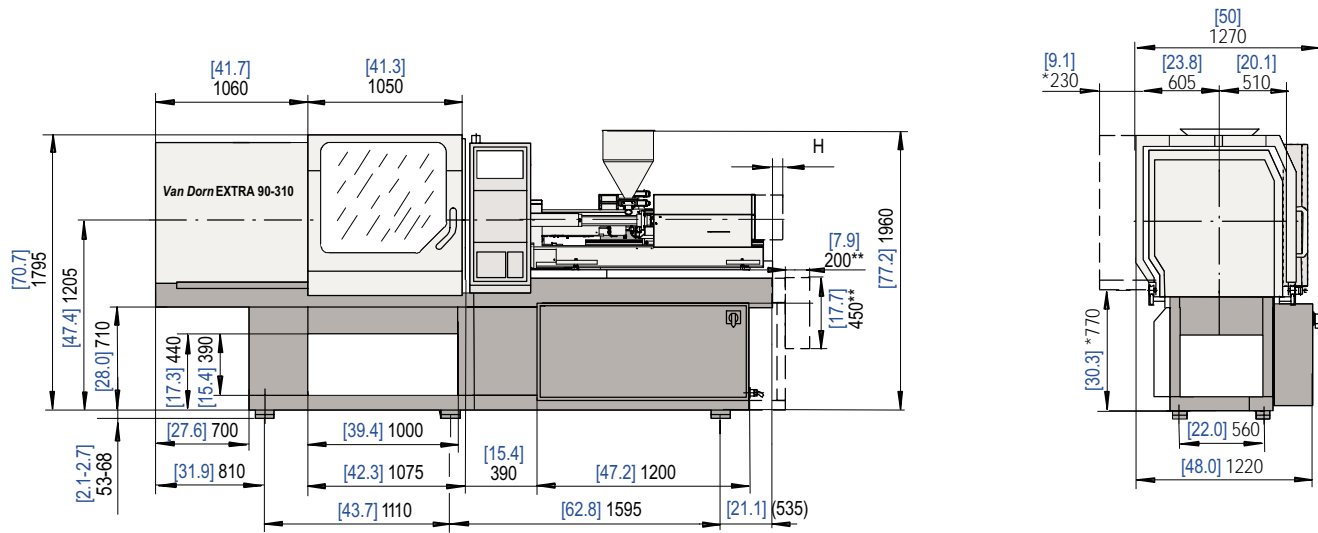

* enlarged safety guard, applicable with sprue picker
 ** Dimensions for hot runner control

Platen dimensions Van Dorn EXTRA 90

Fixed platen

A - A

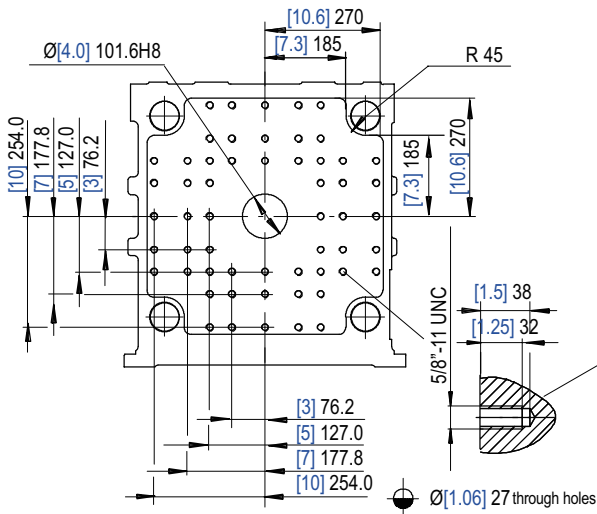

Moving platen

B - B

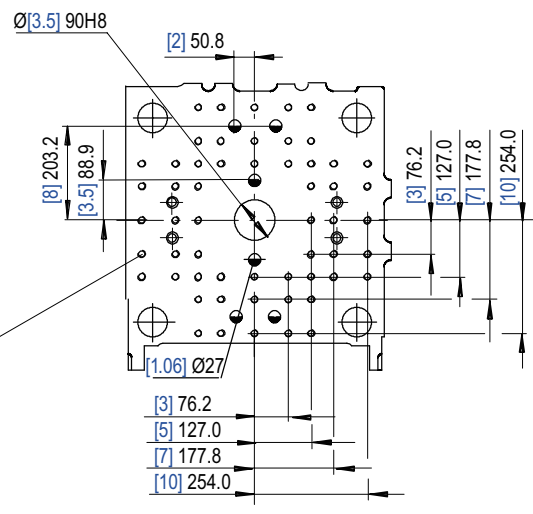

Hole pattern according SPI
 k = minimum permissible mold-Ø 8.5"/215 mm
 Max. permissible mold weight 1124 lbs./510 kg
 max. 770 lbs./350 kg of it on the moving platen support bearings

DemagPlastics Group
VAN DORN

Van Dorn Demag Corporation
 11792 Alameda Drive
 Strongsville, Ohio 44149 USA
 tel: 440/876.8960
 fax: 440/876.4383
 web: www.vandorndemag.com

6/03/1500
 03.13.04.1