

# Technical Data Van Dorn EXTRA 110

Van Dorn Demag		Van Dorn EXTRA 110					
Model description		Van Dorn EXTRA 110-310			Van Dorn EXTRA 110-430		
International size description		1000-310			1000-430		
<b>Clamping unit</b>		<b>110</b>					
Clamping force	[US Tons] [kN]	[112.4] 1000					
Locking force	[USTons] [kN]	[112.4] 1000					
Max. mold opening stroke	[in] [mm]	[19.7] 500					
Min. mold height	[in] [mm]	[9.81/7.9/6.9] 250/200/175 <sup>1)</sup>					
Max. mold height	[in] [mm]	-					
Max. daylight	[in] [mm]	[29.5] 750					
Mold platen (h x v)	[in] [mm]	[21.3x21.3] 540 x 540					
Distance between tie bars (h x v)	[in] [mm]	[15.7x15.7] 400 x 400					
Ejection stroke	[in] [mm]	[5.9] 150					
Ejection force	[US Tons] [kN]	[4.6] 41					
Retraction force	[US Tons] [kN]	[1.7] 15					
<b>Injection unit</b>		<b>310</b>			<b>430</b>		
Screw diameter	[in] [mm]	[1.2] 30	[1.4] 35	[1.6] 40	[1.4] 35	[1.6] 40	[1.8] 45
L/D ratio		20	20	20	20	20	20
Injection pressure (up to 752°F)	[psi] [bar]	[189.9] 2755	[139.5] 2024	[106.8] 1550	[181.9] 2640	[139.6] 2025	[110.3] 1600
Cylinder head volume	[in <sup>3</sup> ] [cm <sup>3</sup> ]	[6.5] 106	[10.3] 168	[13.4] 220	[10.3] 168	[14.1] 231	[17.9] 293
Max. shot weight (PS, PE*)	[oz] [g]	[3.4] 95	[5.4] 152	[7.0] 198	[5.4] 152	[7.3] 208	[9.3] 263
<b>Rate of injection</b>							
> without accumulator	[in <sup>3</sup> ] [cm <sup>3</sup> /s]	[7.3] 120	[9.8] 160	[12.0] 210	[7.3] 120	[9.8] 160	[12.2] 200
> with accumulator	[in <sup>3</sup> ] [cm <sup>3</sup> /s]	-	-	-	-	-	-
<b>Plastizising rate (PS)</b>							
> motor 1 (1740 psi)	[oz/s] [g/s]	[0.66] 18.6	[1.1] 30.0	[1.5] 41.5	[0.85] 24.1	[1.2] 33.3	[1.6] 44.6
> motor 2 (1740 psi)	[oz/s] [g/s]	[0.53] 14.9	[0.85] 24.1	[1.2] 33.3	[0.68] 19.3	[0.94] 26.6	[1.3] 35.7
Max. screw stroke	[in] [mm]	[5.9] 150	[6.9] 175	[6.9] 175	[6.9] 175	[7.2] 184	[7.2] 184
Max. distance of nozzle retraction	[in] [mm]		[9.8] 250			[11.8] 300	
Max. nozzle dipping depth (SVO)	[in] [mm]		[1.8] 45			[1.8] 45	
Nozzle sealing force	[US Tons] [kN]		[6.7] 60			[6.7] 60	
Number of heating zones		4	4	4	4	4	4
Hopper capacity	[gal] [L]		[9.2] 35			[9.2] 35	
<b>General data</b>		<b>110-310</b>			<b>110-430</b>		
Oil tank capacity	[gal] [L]	[47.5] 180			[47.5] 180		
<b>Installed electrical rating</b>							
> pump unit	[hp] [kW]	[24.7] 18.5			[24.7] 18.5		
> heating capacity of screw cylinder	[kw]	8.3	9.4	11.1	9.4	11.1	11.3
> total	[kw]	26.8	27.9	29.6	27.9	29.6	29.8
Dry cycles (EUROMAP 6)	[s-in] [s-mm]	2,86-285			2,86-285		
Net weight (without oil)	[lb] [kg]	[8488.9] 3820			[8555.6] 3850		
Machine dimensions (l x w x h)	[in] [m]	[159.1/50/71.3] 4.04x1.27x1.81			[162.3/50/71.3] 4.13x1.27x1.81		
Screw motor overhang (H) <sup>2)</sup>	[in] [mm]	[0/0] 0/0	[0/1.0] 0/26	[0/5.9] 0/149	[0/0] 0/0	[0/4.3] 0/110	[0/10.5] 0/266

We reserve the right to make changes as a result of further technical advantages. Plasticizing rate depends on processing conditions and material employed.

- 1) max. opening stroke is constant for all mold heights  
2) carriage forward/carriage back

Machine dimensions Van Dorn EXTRA 110

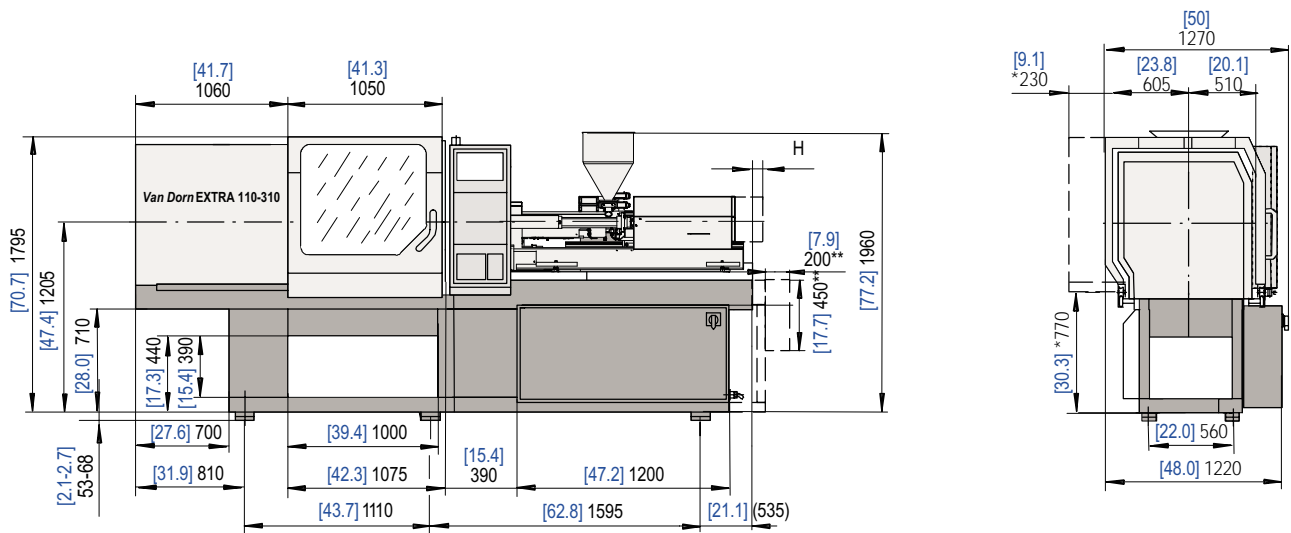

- \* enlarged safety guard, applicable with sprue picker
- \*\* Dimensions for hot runner control

Platen dimensions Van Dorn EXTRA 110

Fixed platen

**A - A**

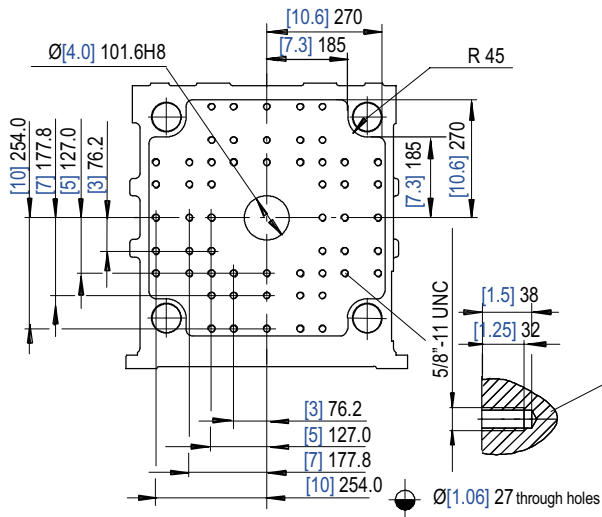

Moving platen

**B - B**

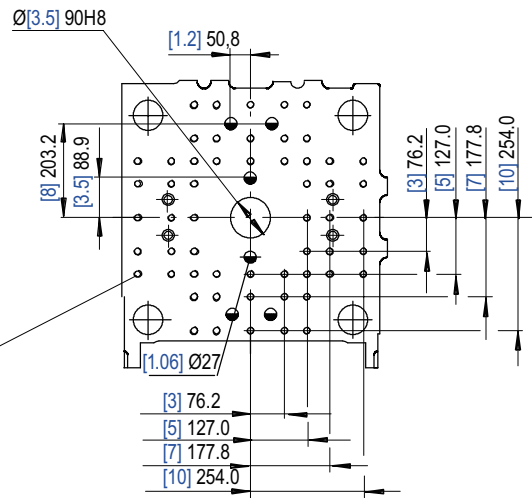

Hole pattern according SPI  
 k = minimum permissible mold-Ø 8.5"/215 mm  
 Max. permissible mold weight 1124 lbs/510 kg  
 max. 770 lbs./350 kg of it on the moving platen support bearings

**Demag**Plastics Group  
**VAN DORN**

Van Dorn Demag Corporation  
 11792 Alameda Drive  
 Strongsville, Ohio 44149 USA  
 tel: 440/876.8960  
 fax: 440/876.4383  
 web: www.vandorndemag.com

6/03/1500  
 03.13.05.1